

DATE 11/12/15
 CATALOG# MP0104

OUTLINE DIMENSIONS
 3-PHASE INDUCTION MOTOR

MOTOR TYPE:
 AESV3W
 FRAME NO. 132M

| | | | | | |
|------|----|-----|----|---------|-------|
| Pole | HP | kW | Hz | VOLT | r/min |
| 4 | 10 | 7.5 | 60 | 230/460 | 1800 |

| | | | | |
|-----|--------|--------------|---------------|------------------------|
| Ins | Rating | Dimension in | Approx Weight | Bearings |
| F | CONT. | mm | 93.0kg | DE: 6308ZZ NDE: 6306ZZ |

Totally Enclosed Fan-Cooled Type. Squirrel-Cage Rotor.

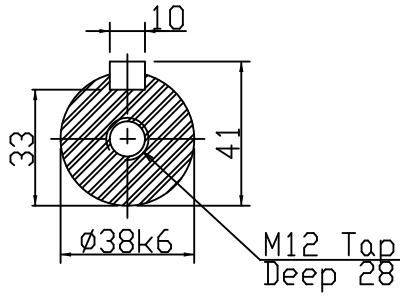
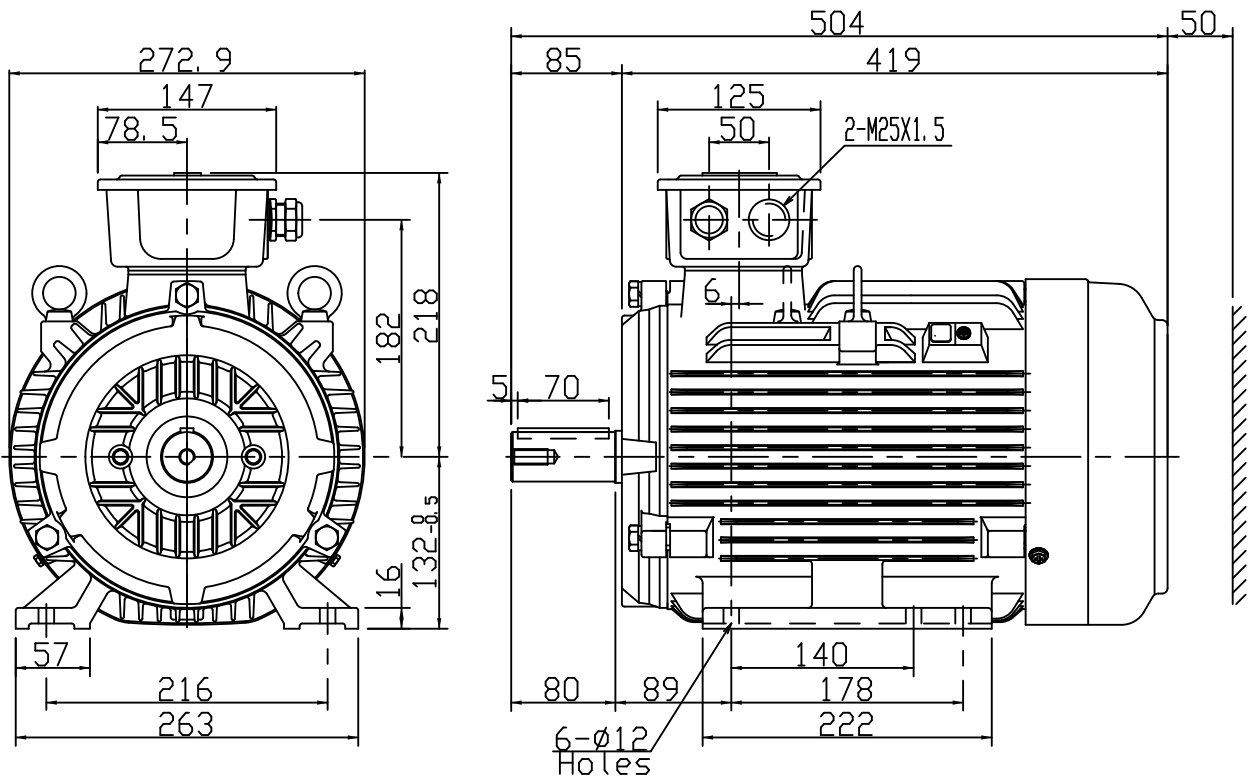

Note:
 1. IP55
 2. F CLASS, B RISE

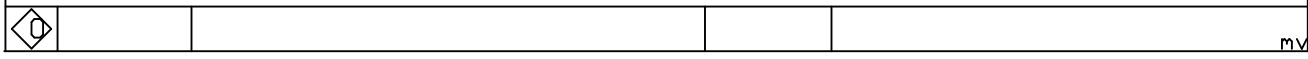

| | | |
|-------|-----|----------|
| DWN. | 譚道勇 | 10-10-13 |
| CHKD. | 時墩慶 | 10-19-13 |
| APPD. | 嚴和欽 | 10-19-13 |



DWG NO.
 32049A154020

WUXI