



## UK434Y-M20

- 4 Contacts
- Metal enclosure
- 3 cable entries M 20 x 1.5
- 62 mm x 127 mm x 50 mm ( basic component)
- Actuator heads can be repositioned by 4 x 90°
- Switching points and contact function adjustable

## Data

### Ordering data

Product type description	UK 434Y
Article number (order number)	101169025
EAN (European Article Number)	4030661294933
eCl@ss number, Version 9.0	27-27-06-01

### Certifications

Certificates	EAC
--------------	-----

### General data

Product name	U 434 offset roller lever K
Standards	EN 60947-5-1
Active principle	mechanical
Slide form	Castor
Enclosure material	Light alloy die-casting
Enclosure coating material	painted
Material of the contacts, electrical	Silver
Roller material	Plastic
Gross weight	460.000 g

### General data - Features

Number of openers	2
Number of shutters	2

## Mechanical data

Actuating element	Offset roller lever
Mechanical life, minimum	10,000,000 Operations
Actuating angle, from left of switch axis	45 °
Actuating angle, from right of switch axis	30 °
Contact opening	2 x 1.5 mm
Actuating speed, minimum	1 mm/min
Actuating speed, maximum	0.5 m/s
Note (Actuating speed)	Actuating speed with vertical actuating angle to switch axis

## Mechanical data - Connection technique

Terminal Connector	Screw connection
Cable section, minimum	1.5 mm <sup>2</sup>
Cable section, maximum	2.5 mm <sup>2</sup>
Note (Cable section)	All indications about the cable section are including the conductor ferrules.
Wire cross-section	13 AWG

## Mechanical data - Dimensions

Height of sensor	165 mm
Length of sensor	50 mm
Width of sensor	62 mm
Width of Castor	8.5 mm
Diameter of Castor	20 mm

## Ambient conditions

Protection class	IP 65 to IEC/EN 60529
Ambient temperature, minimum	-20 °C
Ambient temperature, maximum	+60 °C

## Electrical data

Thermal test current	16 A
Switching element	NC contact NO contact
Switching principle	Creep circuit element

## Notes

Note (General)	Type of contact and switching points can be factory set to order. Actuation from the right should be avoided, since this reduces the mechanical life of the position switch.
----------------	---

## Ordering code

Product type description:

U(1) 434Y-(2)-(3)

(1)

<b>S</b>	Plunger S
<b>K</b>	Offset roller lever K
<b>8H</b>	Roller lever 8H
<b>H</b>	Roller lever H
<b>3H</b>	Roller lever 3H
<b>7H</b>	Roller lever 7H
<b>4H</b>	Spring rod lever on shaft 4H
<b>9H</b>	Rod lever 9H
<b>10H</b>	Rod lever 10H
<b>2H</b>	Leaf spring lever 2H
<b>6H</b>	Leaf spring lever 6H

(2)

<b>without</b>	2 NO contacts/2 NC contact
<b>4OE</b>	4 NC contact
<b>4S</b>	4 NO contacts
<b>1S/3OE</b>	1 NO contacts/3 NC contact
<b>3S/1OE</b>	3 NO contacts/1 NC contact

(3)

<b>1272</b>	Version for low temperatures to -30 °C
-------------	--

## Pictures

### Product picture (catalogue individual photo)



ID: ku43sf04

| 65,9 kB | .png | 74.083 x 120.297 mm - 210 x 341

Pixel - 72 dpi

| 978,8 kB | .jpg | 352.425 x 573.617 mm - 999 x 1626

Pixel - 72 dpi

## Product picture (catalogue individual photo)



ID: ku43kf04

| 148,8 kB | .png | 74.083 x 162.983 mm - 210 x 462

Pixel - 72 dpi

| 573,3 kB | .jpg | 157.339 x 346.428 mm - 446 x 982

Pixel - 72 dpi

## Dimensional drawing basic component

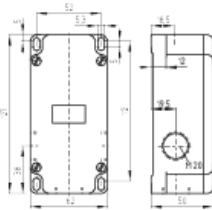

ID: 1u43-g04

| 4,2 kB | .png | 74.083 x 52.211 mm - 210 x 148 Pixel  
- 72 dpi

| 91,2 kB | .jpg | 352.778 x 248.003 mm - 1000 x 703

Pixel - 72 dpi

| 27,6 kB | .cdr |

## Switch travel diagram



ID: ku43-s02

| 53,5 kB | .jpg | 352.778 x 182.739 mm - 1000 x 518  
Pixel - 72 dpi

| 1,1 kB | .png | 74.083 x 52.564 mm - 210 x 149 Pixel  
- 72 dpi

## Diagram

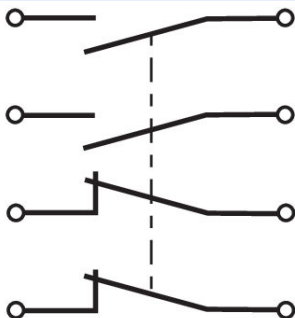

ID: k2o2sk04

| 19,1 kB | .cdr |

## Operating principle

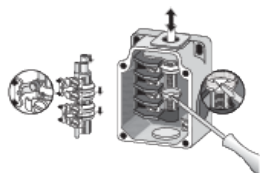

ID: ku432a01

| 19,8 kB | .png | 74.083 x 49.742 mm - 210 x 141

Pixel - 72 dpi

| 203,1 kB | .cdr |

| 157,4 kB | .jpg | 352.778 x 236.361 mm - 1000 x 670

Pixel - 72 dpi

## Operating principle



ID: 235rz03

| 131,9 kB | .jpg | 352.778 x 773.642 mm - 1000 x 2193 Pixel - 72 dpi

| 2,7 kB | .png | 74.083 x 162.278 mm - 210 x 460

Pixel - 72 dpi

| 15,5 kB | .cdr |

## Dimensional drawing actuator

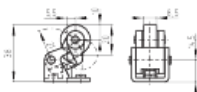

ID: 1u43kb01

| 64,7 kB | .jpg | 352.778 x 247.297 mm - 1000 x 701

Pixel - 72 dpi

| 3,5 kB | .png | 74.083 x 51.858 mm - 210 x 147 Pixel - 72 dpi

K.A. Schmersal GmbH & Co. KG, Möddinghofe 3, D-42279 Wuppertal

The details and data referred to have been carefully checked. Images may diverge from original. Further technical data can be found in the manual. Technical amendments and errors possible.

Generated on 17.09.2020 19:14:39