

Archive



TS 470-33Y

- 4 cable entries M 20 x 1.5

Data

Ordering data

Note (Delivery capacity)	Not available!
Product type description	TS 470-33Y
Article number (order number)	101058514
EAN (European Article Number)	4030661253725

Certifications

Certificates	EAC DNV GL
--------------	---------------

General data

Product name	470 plunger S
Slide form	Sphere
Gross weight	2760.000 g

General data - Features

Number of openers	3
Number of shutters	3

Mechanical data

Actuating element	Plunger
Mechanical life, minimum	10,000,000 Operations
Actuating angle	20 °

Contact opening	max. 2 x 6 mm
Actuating speed, minimum	1 mm/min
Actuating speed, maximum	1 m/s
Note (Actuating speed)	Actuating speed with vertical actuating angle to switch axis

Mechanical data - Connection technique

Terminal Connector	Screw connection
Cable section, minimum	1.5 mm ²
Cable section, maximum	2.5 mm ²
Note (Cable section)	All indications about the cable section are including the conductor ferrules.
Wire cross-section	13 AWG

Mechanical data - Dimensions

Height of sensor	220 mm
Length of sensor	64 mm
Width of sensor	130 mm
Diameter of the Plunger	10 mm

Electrical data

Utilisation category AC-15	400 VAC
Utilisation category AC-15	4 A
Switching element	NO contact, NC contact
Note (Switching element)	with double break
Switching principle	Creep circuit element

Notes

Note (General)	Actuation from the side of the plunger should be avoided, since this reduces the mechanical life of the position switch.
----------------	--

Pictures

Product picture (catalogue individual photo)



ID: bt441f01

| 25,4 kB | .png | 74.083 x 68.086 mm - 210 x 193

Pixel - 72 dpi

| 295,6 kB | .jpg | 352.778 x 323.497 mm - 1000 x 917

Pixel - 72 dpi

Dimensional drawing actuator

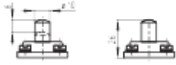

ID: 1t422b01

| 2,2 kB | .png | 74.083 x 51.858 mm - 210 x 147 Pixel
- 72 dpi

| 33,5 kB | .jpg | 352.778 x 247.297 mm - 1000 x 701
Pixel - 72 dpi

Operating principle



ID: 235sz01

| 1,8 kB | .png | 74.083 x 251.883 mm - 210 x 714
Pixel - 72 dpi

| 95,3 kB | .jpg | 352.778 x 1199.444 mm - 1000 x
3400 Pixel - 72 dpi



| 14,1 kB | .cdr |

K.A. Schmersal GmbH & Co. KG, Möddinghofe 3, D-42279 Wuppertal

The details and data referred to have been carefully checked. Images may diverge from original. Further technical data can be found in the manual. Technical amendments and errors possible.

Generated on 17.09.2020 16:59:35