



TK422-01Y

- 1 Contact
- Metal enclosure
- Protection class IP65
- 2 cable entries M 20 x 1.5
- 106 mm x 71 mm x 63 mm (basic component)
- Actuator heads can be repositioned by 4 x 90°

Data

Ordering data

Product type description	TK 422-01Y
Article number (order number)	101058889
EAN (European Article Number)	4030661034133
eCl@ss number, Version 9.0	27-27-06-01

Certifications

Certificates	CCC
	EAC
	DNV GL

General data

Product name	422 offset roller lever K
Standards	EN 60947-5-1
Active principle	mechanical
Slide form	Castor
Enclosure material	Grey cast iron, galvanised
Enclosure coating material	painted
Material of the contacts, electrical	Silver
Roller material	Plastic
Gross weight	1015.000 g

General data - Features

Number of openers	1
-------------------	---

Mechanical data

Actuating element	Offset roller lever
Mechanical life, minimum	10,000,000 Operations
Actuating angle, from left of switch axis	45 °
Actuating angle, from right of switch axis	30 °
Contact opening	2 x 6 mm
Actuating speed, minimum	1 mm/min
Actuating speed, maximum	0.5 m/s
Note (Actuating speed)	Actuating speed with vertical actuating angle to switch axis

Mechanical data - Connection technique

Terminal Connector	Screw connection
Cable section, minimum	1.5 mm ²
Cable section, maximum	2.5 mm ²
Note (Cable section)	All indications about the cable section are including the conductor ferrules.
Wire cross-section	13 AWG

Mechanical data - Dimensions

Height of sensor	145 mm
Length of sensor	63 mm
Width of sensor	106 mm
Width of Castor	6.5 mm
Diameter of Castor	25 mm

Ambient conditions

Protection class	IP 65 to IEC/EN 60529
Ambient temperature, minimum	-30 °C
Ambient temperature, maximum	+90 °C

Electrical data

Thermal test current	16 A
Utilisation category AC-15	400 VAC
Utilisation category AC-15	4 A
Switching element	Opener (NC)
Note (Switching element)	with double break
Switching principle	Creep circuit element

Notes

Note (General)

Actuation from the right should be avoided, since this reduces the mechanical life of the position switch.

Pictures

Product picture (catalogue individual photo)



ID: kt422f05

| 73,6 kB | .png | 73.731 x 105.481 mm - 209 x 299
Pixel - 72 dpi

| 679,0 kB | .jpg | 225.072 x 321.381 mm - 638 x 911
Pixel - 72 dpi

Dimensional drawing basic component

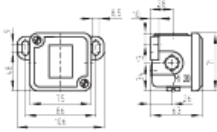

ID: 1t422g01

| 3,6 kB | .png | 74.083 x 51.858 mm - 210 x 147 Pixel
- 72 dpi

| 29,4 kB | .cdr |

| 82,3 kB | .jpg | 352.778 x 247.297 mm - 1000 x 701
Pixel - 72 dpi

Switch travel diagram



ID: kt422s04

| 833,0 b | .png | 74.083 x 52.564 mm - 210 x 149
Pixel - 72 dpi

Dimensional drawing actuator

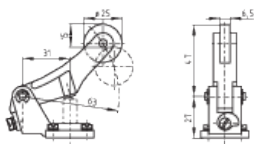

ID: 1t422b04

| 94,0 kB | .jpg | 352.778 x 247.297 mm - 1000 x 701
Pixel - 72 dpi

| 9,6 kB | .png | 74.083 x 51.858 mm - 210 x 147 Pixel
- 72 dpi

Operating principle



ID: 235rz03

| 131,9 kB | .jpg | 352.778 x 773.642 mm - 1000 x 2193 Pixel - 72 dpi

| 2,7 kB | .png | 74.083 x 162.278 mm - 210 x 460 Pixel - 72 dpi

| 15,5 kB | .cdr |

K.A. Schmersal GmbH & Co. KG, Möddinghofe 3, D-42279 Wuppertal

The details and data referred to have been carefully checked. Images may diverge from original. Further technical data can be found in the manual. Technical amendments and errors possible.

Generated on 16.09.2020 22:50:19