



### MSP452-11/11Y-M20

- 4 Contacts
- Metal enclosure
- 2 cable entries
- 118 mm x 174 mm x 64 mm

## Data

### Ordering data

Product type description	MSP 452-11/11Y
Article number (order number)	101160615
EAN (European Article Number)	4030661190815
eCl@ss number, Version 9.0	27-27-26-01

### General data

Product name	MSP 452
Standards	EN 60947-5-1
Active principle	mechanical
Slide form	Curvature
Enclosure material	Grey cast iron, galvanised
Enclosure coating material	painted
Gross weight	1735.000 g

### General data - Features

Number of openers	2
Number of shutters	1

### Mechanical data

Actuating element	Plunger
-------------------	---------

Mechanical life, minimum	3,000,000 Operations
Contact opening	2 x 0.5 mm
Actuating torque	0.20 Nm

#### **Mechanical data - Connection technique**

Terminal Connector	Screw connection
Cable section, minimum	1.5 mm <sup>2</sup>
Cable section, maximum	2.5 mm <sup>2</sup>
Note (Cable section)	All indications about the cable section are including the conductor ferrules.
Wire cross-section	12 AWG

#### **Mechanical data - Dimensions**

Height of sensor	174 mm
Length of sensor	64 mm
Width of sensor	118 mm
Diameter of the Plunger	10 mm

#### **Ambient conditions**

Protection class	IP 65 to IEC/EN 60529
Ambient temperature, minimum	-30 °C
Ambient temperature, maximum	+90 °C

#### **Ambient conditions - Insulation value**

Rated impulse withstand voltage	4 kV
---------------------------------	------

#### **Electrical data**

Thermal test current	6 A
Utilisation category AC-15	230 VAC
Utilisation category AC-15	2.5 A
Switching element	NO contact / NC contact
Switching principle	Snap switch element
Bounce duration, maximum	43,221 ms
Switchover time, maximum	10 ms

## Notes

### Note (General)

This rotating spindle limit switch with snap-action insert is only fit for use in normal to average operating conditions, e.g. for machine tools, cranes and conveyors. Protection class IP 65 to IEC/EN 60529. By reversing the contacts, the spindle revolutions can be set between 4 and 55 revolutions. The run-out towards each side is at least 5 revolutions.

## Pictures

### Product picture (catalogue individual photo)



ID: kmsp4f01

| 65,6 kB | .png | 74.083 x 111.125 mm - 210 x 315  
Pixel - 72 dpi  
| 804,9 kB | .jpg | 352.778 x 529.167 mm - 1000 x  
1500 Pixel - 72 dpi

### Dimensional drawing basic component

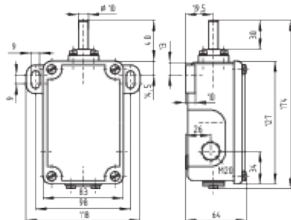

ID: 1msp4g01

| 10,4 kB | .png | 74.083 x 51.858 mm - 210 x 147  
Pixel - 72 dpi  
| 132,2 kB | .jpg | 352.778 x 247.297 mm - 1000 x 701  
Pixel - 72 dpi  
| 36,4 kB | .cdr |

### Switch travel diagram

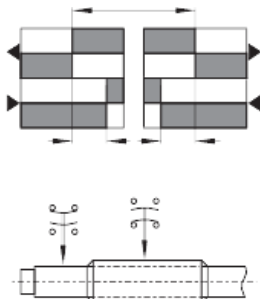

ID: kmsp4s01

| 20,3 kB | .cdr |  
| 2,9 kB | .png | 74.083 x 68.439 mm - 210 x 194 Pixel  
- 72 dpi  
| 88,9 kB | .jpg | 352.778 x 326.319 mm - 1000 x 925  
Pixel - 72 dpi

K.A. Schmersal GmbH & Co. KG, Möddinghofe 3, D-42279 Wuppertal

The details and data referred to have been carefully checked. Images may diverge from original. Further technical data can be found in the manual. Technical amendments and errors possible.

Generated on 18.09.2020 21:58:15