



MJ441-11Y-M20

- 2 Contacts
- Metal enclosure
- Protection class IP65
- 2 cable entries M 20 x 1.5
- 106 mm x 99 mm x 63 mm (basic component)
- Actuator heads can be repositioned by 4 x 90°

Data

Ordering data

Product type description	MJ 441-11Y
Article number (order number)	101059115
EAN (European Article Number)	4030661034829
eCl@ss number, Version 9.0	27-27-06-01

Certifications

Certificates	CCC
	EAC
	DNV GL

General data

Product name	441 offset roller lever J
Standards	EN 60947-5-1
Active principle	mechanical
Slide form	Castor
Enclosure material	Grey cast iron, galvanised
Enclosure coating material	painted
Material of the contacts, electrical	Silver
Roller material	Plastic
Gross weight	1575.000 g

General data - Features

Number of openers	1
Number of shutters	1

Mechanical data

Actuating element	Offset roller lever
Mechanical life, minimum	5,000,000 Operations
Actuating angle, from left of switch axis	45 °
Actuating angle, from right of switch axis	30 °
Contact opening	2 x 2.5 mm
Actuating speed, minimum	1 mm/min
Actuating speed, maximum	0.5 m/s
Note (Actuating speed)	Actuating speed with vertical actuating angle to switch axis

Mechanical data - Connection technique

Terminal Connector	Screw connection
Cable section, minimum	1.5 mm ²
Cable section, maximum	2.5 mm ²
Note (Cable section)	All indications about the cable section are including the conductor ferrules.
Wire cross-section	13 AWG

Mechanical data - Dimensions

Height of sensor	179 mm
Length of sensor	63 mm
Width of sensor	106 mm
Width of Castor	9 mm
Diameter of Castor	36 mm

Ambient conditions

Protection class	IP 65 to IEC/EN 60529
Ambient temperature, minimum	-30 °C
Ambient temperature, maximum	+90 °C

Ambient conditions - Insulation value

Rated impulse withstand voltage	4 kV
---------------------------------	------

Electrical data

Thermal test current	16 A
Utilisation category AC-15	250 VAC
Utilisation category AC-15	4 A
Switching element	NO contact, NC contact
Note (Switching element)	galvanically separated contact bridges

Switching principle	Snap switch element
Bounce duration, maximum	5 ms
Switchover time, maximum	35 ms

Notes

Note (General)	Actuation from the right should be avoided, since this reduces the mechanical life of the position switch.
----------------	--

Ordering code

Product type description:

(1)(2) 441-11Y(3)-(4)-(5)

(1)

T	Slow action
M	Snap action

(2)

S	Plunger S
2S	Telescopic plunger 2S
R	Roller plunger R
K	Offset roller lever K
J	Offset roller lever J
2C	Fork lever 2C
L	Roller lever L
D	Roller lever D

(3)

UE	Slow action with overlapping contacts
-----------	---------------------------------------

(4)

without	Cast iron enclosure
A	Aluminium enclosure

(5)

T	temperature-resistant and tropical version with ceramic insulation for -40 °C ... +200 °C
1276-2	Gold-plated contacts

Pictures

Product picture (catalogue individual photo)



ID: kt441f06

| 878,0 kB | .jpg | 228.6 x 384.175 mm - 648 x 1089

Pixel - 72 dpi

| 93,8 kB | .png | 73.731 x 124.178 mm - 209 x 352

Pixel - 72 dpi

Dimensional drawing basic component

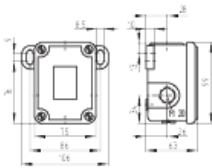

ID: 1t441g01

| 86,4 kB | .jpg | 352.778 x 247.297 mm - 1000 x 701

Pixel - 72 dpi

| 29,6 kB | .cdr |

| 3,9 kB | .png | 74.083 x 51.858 mm - 210 x 147 Pixel

- 72 dpi

Switch travel diagram



ID: kt441s10

| 1,1 kB | .png | 74.083 x 52.564 mm - 210 x 149 Pixel

- 72 dpi

Dimensional drawing actuator

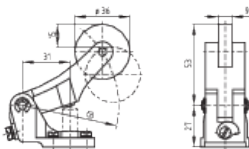

ID: 1t422b05

| 100,7 kB | .jpg | 352.778 x 247.297 mm - 1000 x 701

Pixel - 72 dpi

| 10,4 kB | .png | 74.083 x 51.858 mm - 210 x 147

Pixel - 72 dpi

Operating principle



ID: 235rz03



| 131,9 kB | .jpg | 352.778 x 773.642 mm - 1000 x 2193 Pixel - 72 dpi

| 2,7 kB | .png | 74.083 x 162.278 mm - 210 x 460 Pixel - 72 dpi

| 15,5 kB | .cdr |

K.A. Schmersal GmbH & Co. KG, Möddinghofe 3, D-42279 Wuppertal

The details and data referred to have been carefully checked. Images may diverge from original. Further technical data can be found in the manual. Technical amendments and errors possible.

Generated on 14.09.2020 17:42:58