



### M. 441-11Y-966

- 2 Contacts
- Metal enclosure
- 2 cable entries M20
- Suitable for heavy duty
- 106 mm x 99 mm x 63 mm ( basic component)

## Data

### Ordering data

Product type description	M. 441-11Y-966
Article number (order number)	101092366
EAN (European Article Number)	4030661031972
eCl@ss number, Version 9.0	27-27-06-90

### General data

Product name	441 belt alignment switch
Standards	EN 60947-5-1
Active principle	mechanical
Enclosure material	Grey cast iron, galvanised
Enclosure coating material	painted
Material of the contacts, electrical	Silver
Gross weight	2049.000 g

### General data - Features

Number of openers	1
Number of shutters	1

### Mechanical data

Mechanical life, minimum	10,000,000 Operations
Contact opening	2 x 2.5 mm
Actuation direction	each time 60° right-hand side and left-hand side rotation

### Mechanical data - Connection technique

Terminal Connector	Screw connection
Cable section, minimum	1.5 mm <sup>2</sup>
Cable section, maximum	2.5 mm <sup>2</sup>

### Mechanical data - Dimensions

Height of sensor	99 mm
Length of sensor	63 mm
Width of sensor	106 mm
Diameter of Castor	32 mm
Height of the lever	159 mm
Width of the lever	32 mm
Length of the lever	32 mm

### Ambient conditions

Protection class	IP 65 to IEC/EN 60529
Ambient temperature, minimum	-30 °C
Ambient temperature, maximum	+90 °C

### Ambient conditions - Insulation value

Rated impulse withstand voltage	4 kV
---------------------------------	------

### Electrical data

Thermal test current	16 A
Utilisation category AC-15	230 VAC
Utilisation category AC-15	4 A
Switching element	NO contact, NC contact
Switching principle	Snap switch element
Switching frequency	3,000 /h

### Pictures

### Product picture (catalogue individual photo)



ID: kbandf06

| 125,1 kB | .png | 74.083 x 221.897 mm - 210 x 629

Pixel - 72 dpi

| 369,4 kB | .jpg | 176.389 x 529.167 mm - 500 x 1500

Pixel - 72 dpi

### Product picture (catalogue individual photo)



ID: ktm44f02

| 567,7 kB | .jpg | 214.136 x 529.167 mm - 607 x 1500

Pixel - 72 dpi

| 101,8 kB | .png | 74.083 x 182.739 mm - 210 x 518

Pixel - 72 dpi

### Dimensional drawing basic component

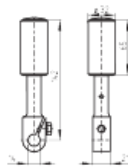

ID: 1bandb01

| 23,1 kB | .cdr |

| 2,8 kB | .png | 74.083 x 51.858 mm - 210 x 147 Pixel

- 72 dpi

| 51,1 kB | .jpg | 352.778 x 247.297 mm - 1000 x 701

Pixel - 72 dpi

### Switch travel diagram



ID: kt441s12

| 1,3 kB | .png | 74.083 x 52.564 mm - 210 x 149 Pixel

- 72 dpi

| 78,0 kB | .jpg | 352.778 x 260.703 mm - 1000 x 739

Pixel - 72 dpi

K.A. Schmersal GmbH & Co. KG, Möddinghofe 3, D-42279 Wuppertal

The details and data referred to have been carefully checked. Images may diverge from original. Further technical data can be found in the manual. Technical amendments and errors possible.

Generated on 18.09.2020 19:16:05