



M2K015-11Y

- 2 Contacts
- Metal enclosure
- 3 Cable entry M 20 x 1.5
- 67 mm x 75 mm x 43 mm (basic component)
- Free movement of actuator from other side
- Actuator heads can be repositioned by 4 x 90°

Data

Ordering data

Product type description	M2K 015-11Y
Article number (order number)	101054748
EAN (European Article Number)	4030661001487
eCl@ss number, Version 9.0	27-27-06-01

Certifications

Certificates	CCC
	EAC

General data

Product name	015 tilt lever 2K
Standards	EN 60947-5-1
Active principle	mechanical
Slide form	Castor
Enclosure material	Light-alloy diecast, paint finish
Enclosure coating material	painted
Material of the contacts, electrical	Silver
Roller material	Plastic
Gross weight	270.000 g

General data - Features

Number of openers	1
Number of shutters	1

Mechanical data

Actuating element	Tilt lever
Mechanical life, minimum	10,000,000 Operations
Actuating angle, from left of switch axis	45 °
Actuating angle, from right of switch axis	60 °
Actuating force	5 N
Contact opening	2 x 1.2 mm
Actuating speed, minimum	1 mm/min
Actuating speed, maximum	0.5 m/s
Note (Actuating speed)	Actuating speed with vertical actuating angle to switch axis

Mechanical data - Connection technique

Terminal Connector	Screw connection
Cable section, maximum	2.5 mm ²
Note (Cable section)	All indications about the cable section are including the conductor ferrules.
Wire cross-section	13 AWG

Mechanical data - Dimensions

Height of sensor	130 mm
Length of sensor	43 mm
Width of sensor	67 mm
Width of Castor	8.5 mm
Diameter of Castor	20 mm

Ambient conditions

Protection class	IP 65 to IEC/EN 60529
Ambient temperature, minimum	-30 °C
Ambient temperature, maximum	+90 °C

Electrical data

Thermal test current	10 A
Utilisation category AC-15	400 VAC
Utilisation category AC-15	2.5 A
Switching element	NO contact, NC contact
Note (Switching element)	galvanically separated contact bridges
Switching principle	Snap switch element
Bounce duration, maximum	2.5 ms
Switchover time, maximum	40 ms

Notes

Note (General)

Actuation only possible from one side

Ordering code

Product type description:

(1)(2) 015-(3)Y-(4)

(1)

T Slow action
M Snap action

(2)

S Plunger S
2S Telescopic plunger 2S
K Offset roller lever K
2K Tilt lever 2K
3K Angle roller lever 3K
8H Roller lever 8H
7H Roller lever 7H
10H Rod lever 10H
H Roller lever H
4H Spring rod lever on shaft 4H
2H Leaf spring lever 2H
3H Roller lever 3H
9H Rod lever 9H
6H Leaf spring lever 6H

(3)

11 1 NO contacts/1 NC contact
02 2 NC contact
20 2 NO contacts

(4)

UE Slow action with overlapping contacts
H Slow action with staggered contacts
C Magnetic blow-out

Dimensional drawing actuator

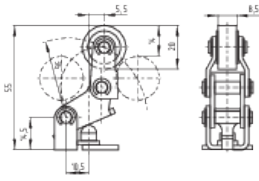

ID: 1t15kb02

| 11,8 kB | .png | 74.083 x 51.858 mm - 210 x 147

Pixel - 72 dpi

| 118,8 kB | .jpg | 352.778 x 247.297 mm - 1000 x 701

Pixel - 72 dpi

Operating principle



ID: 235rz03

| 131,9 kB | .jpg | 352.778 x 773.642 mm - 1000 x 2193
Pixel - 72 dpi

| 2,7 kB | .png | 74.083 x 162.278 mm - 210 x 460
Pixel - 72 dpi

| 15,5 kB | .cdr |

K.A. Schmersal GmbH & Co. KG, Möddinghofe 3, D-42279 Wuppertal

The details and data referred to have been carefully checked. Images may diverge from original. Further technical data can be found in the manual. Technical amendments and errors possible.

Generated on 11.09.2020 19:05:47