



## AZM190-02/01RKA-24VDC

- Thermoplastic enclosure
- Long life
- Interlock with protection against incorrect locking.
- 89 mm x 178 mm x 41 mm
- Actuating head can be repositioned by 4 x 90°
- 2 cable entries M 20 x 1.5
- Wiring compartment
- Slim design, particularly suitable for fitting on hinged doors, aluminium profiles and fencing
- Sealing mechanism to prevent the ingress of dirt
- Cut clamp termination

## Data

### Ordering data

Replacement article number	101031685
Product type description	AZM190-02/01RKA-24VDC
Article number (order number)	131031685
EAN (European Article Number)	8905236105630
eCl@ss number, version 12.0	27-27-26-03
eCl@ss number, version 11.0	27-27-26-03
eCl@ss number, version 9.0	27-27-26-03
ETIM number, version 7.0	EC002593
ETIM number, version 6.0	EC002593

### Approvals - Standards

Certificates

TÜV  
cULus  
CCC  
EAC

## General data

Standards	BG-GS-ET-19 EN IEC 60947-5-1
Coding level according to EN ISO 14119	Low
Working principle	electromechanical
Enclosure material	Glass-fibre, reinforced thermoplastic
Material of the contacts, electrical	Silver
Gross weight	480 g

## General data - Features

Power to lock	Yes
Manual release	Yes
Number of actuating directions	4
Number of cable glands	2
Number of safety contacts	3

## Safety classification

Standards	EN ISO 13849-1
Mission time	20 Year(s)

## Safety classification - Safety outputs

B <sub>10D</sub> Normally-closed contact (NC)	2,000,000 Operations
B <sub>10D</sub> Normally open contact (NO)	1,000,000 Operations

## Mechanical data

Mechanical life, minimum	1,000,000 Operations
Holding force	1,950 N
Latching force	20 N
Positive break force, minimum	20 N
Actuating speed, maximum	0.3 m/s

## Mechanical data - Connection technique

Termination	Screw terminals
Cable entry	M20 cable gland
Cable section, minimum	1 x 0.5 mm <sup>2</sup>
Cable section, maximum	1 x 1.5 mm <sup>2</sup>
Note (Cable section)	All indications including the conductor ferrules.

## Mechanical data - Dimensions

Length of sensor	41 mm
Width of sensor	52 mm
Height of sensor	178 mm

## Ambient conditions

Degree of protection	IP67
Ambient temperature, minimum	+0 °C
Ambient temperature, maximum	+50 °C

## Ambient conditions - Insulation values

Rated insulation voltage $U_i$	250 V
Rated impulse withstand voltage $U_{imp}$	4 kV

## Electrical data

Thermal test current	4 A
Required rated short-circuit current to EN 60947-5-1	1,000 A
Electrical power consumption, maximum	8.5 W
Switching principle	Slow action
Switching frequency	1.2 /h

## Electrical data - Safety contacts

Voltage, Utilisation category AC-15	230 VAC
Current, Utilisation category AC-15	4 A
Voltage, Utilisation category DC-13	24 VDC
Current, Utilisation category DC-13	4 A

## Electrical data - Auxiliary contacts

Voltage, Utilisation category AC-15	230 VAC
Current, Utilisation category AC-15	4 A
Voltage, Utilisation category DC-13	24 VDC
Current, Utilisation category DC-13	4 A

## Other data

Note (applications)	sliding safety guard removable guard hinged safety guard
---------------------	--

## Scope of delivery

Scope of delivery	Actuators must be ordered separately.
-------------------	---------------------------------------

## Note

Note (Manual release)

front  
For maintenance, installation, etc.

## Ordering code

Product type description:  
AZM190-(1)RK(2)(3)-(4)-(5)

(1)

---

<b>02/01</b>	Magnet: 2 NC contacts; actuator: 1 NC contact
<b>02/02</b>	Magnet: 2 NC contacts; actuator: 2 NC contacts
<b>02/10</b>	Magnet: 2 NC contacts; actuator: 1 NO contact
<b>02/11</b>	Magnet: 2 NC contacts; actuator: 1 NC contact/1 NO contact
<b>11/01</b>	Magnet: 1 NC contact/1 NO contact; actuator: 1 NC contact
<b>11/02</b>	Magnet: 1 NC contact/1 NO contact; actuator: 2 NC contacts
<b>11/10</b>	Magnet: 1 NC contact/1 NO contact; actuator: 1 NO contact
<b>11/11</b>	Magnet: 1 NC contact/1 NO contact; actuator: 1 NC contact/1 NO contact

(2)

---

<b>without</b>	Power to unlock
<b>A</b>	Power to lock

(3)

---

<b>without</b>	With manual release on the cover side
<b>E0</b>	Without manual release
<b>E1</b>	With manual release from side (right)
<b>N</b>	Emergency release
<b>T</b>	Emergency exit

(4)

**without**

without LED switching conditions display

**G**

With LED switching conditions display (for 24 V AC/DC only; cannot be combined with -E1 and -T)

(5)

**24VAC**

Us: 24 VAC

**24 VDC**

Us: 24 VDC

**48VAC**

Us: 48 VAC

**110VAC**

Us: 110 VAC

**230VAC**

Us: 230 VAC

## Pictures

### Product picture (catalogue individual photo)



ID: kazm1f12

| 470.6 kB | .jpg | 245.533 x 444.5 mm - 696 x 1260 px - 72 dpi

| 72.8 kB | .png | 74.083 x 134.056 mm - 210 x 380 px - 72 dpi

### Dimensional drawing basic component

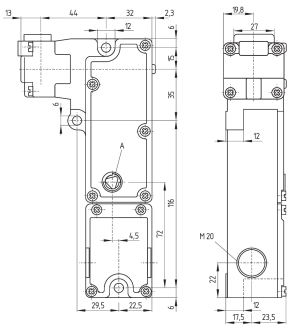

ID: kazm1g26

| 109.5 kB | .ai | 210.002 x 297 mm - 595 x 841 px - 72 dpi

| 6.9 kB | .png | 74.083 x 83.256 mm - 210 x 236 px - 72 dpi

| 203.5 kB | .jpg | 352.778 x 396.522 mm - 1000 x 1124 px - 72 dpi

Schmersal, Inc., 15 Skyline Drive, Hawthorne, NY 10532

The details and data referred to have been carefully checked. Images may diverge from original. Further technical data can be found in the manual. Technical amendments and errors possible.

Generated on: 9/23/2022, 11:46 AM