



## TESZX1102/S

- 2 cable entries M 20 x 1.5
- Simple fitting, especially on 40 mm profiles
- Thermoplastic enclosure
- Double-insulated
- Good resistance to oil and petroleum spirit
- 111,5 mm x 92 mm x 36 mm

## Data

### Ordering data

|                               |               |
|-------------------------------|---------------|
| Product type description      | TESZX1102/S   |
| Article number (order number) | 101031672     |
| EAN (European Article Number) | 4030661449173 |
| eCl@ss number, version 12.0   | 27-27-06-09   |
| eCl@ss number, version 11.0   | 27-27-06-09   |
| eCl@ss number, version 9.0    | 27-27-06-09   |
| ETIM number, version 7.0      | EC002591      |
| ETIM number, version 6.0      | EC002591      |

### Approvals - Standards

|              |                           |
|--------------|---------------------------|
| Certificates | BG<br>IFA<br>cULus<br>CCC |
|--------------|---------------------------|

## General data

|                       |   |
|-----------------------|---|
| Standards             | BG-GS-ET-15<br>EN IEC 60947-5-1                                   |
| Housing material      | Plastic, glass-fibre reinforced thermoplastic, self-extinguishing |
| Material of the hinge | Stainless steel   |
| Gross weight          | 467 g   |

## General data - Features

|                              |     |
|------------------------------|-----|
| mounting hinge               | Yes |
| Number of auxiliary contacts | 1   |
| Number of safety contacts    | 2   |

## Safety classification

|              |                |
|--------------|----------------|
| Standards    | EN ISO 13849-1 |
| Mission time | 20 Year(s)     |

## Safety classification - Safety outputs

|   |                      |
|---|----------------------|
| B <sub>10D</sub> Normally-closed contact (NC) | 2,000,000 Operations |
| B <sub>10D</sub> Normally open contact (NO)   | 1,000,000 Operations |

## Mechanical data

|                               |                      |
|-------------------------------|----------------------|
| Mechanical life, minimum      | 1,000,000 Operations |
| Positive break angle          | 14 °                 |
| Positive break force, minimum | 1 N                  |

## Mechanical data - Connection technique

|                        |   |
|------------------------|---|
| Termination            | Screw terminals M20 x 1.5                         |
| Cable section, minimum | 0.5 mm <sup>2</sup>                               |
| Cable section, maximum | 1 mm <sup>2</sup>                                 |
| Note (Cable section)   | All indications including the conductor ferrules. |

## Mechanical data - Dimensions

|                         |   |
|-------------------------|---|
| Length x Width x Height | Suitable for mounting to profile systems: 40 mm |
| Length of sensor        | 36 mm   |
| Width of sensor         | 111.5 mm  |
| Height of sensor        | 92 mm   |

## Ambient conditions

|                      |                |
|----------------------|----------------|
| Degree of protection | IP65           |
| Ambient temperature  | -25 ... +65 °C |

## Ambient conditions - Insulation values

|   |         |
|---|---------|
| Rated insulation voltage $U_i$            | 250 VAC |
| Rated impulse withstand voltage $U_{imp}$ | 2.5 kV  |

## Electrical data

|                            |         |
|----------------------------|---------|
| Thermal test current       | 2.5 A   |
| Utilisation category AC-15 | 230 VAC |
| Utilisation category AC-15 | 2 A     |
| Utilisation category DC-13 | 24 VDC  |
| Utilisation category DC-13 | 1 A     |

|                                      |                        |
|--------------------------------------|------------------------|
| Switching element                    | NO contact, NC contact |
| Switching principle                  | Slow action            |
| Switching frequency                  | 120 /h                 |
| Material of the contacts, electrical | Silver                 |

## Note

|                |   |
|----------------|---|
| Note (General) | The opening angle has been set to 4° in factory.<br>The additional hinge including mounting accessories is also available separately, part number TESZX/S |
|----------------|---|

## Ordering code

Product type description:  
TESZ(1)(2)(3)(4)/(5)(6)/(7)

(1)

|                |                                       |
|----------------|---------------------------------------|
| <b>without</b> | Material of the hinge Aluminium       |
| <b>X</b>       | Material of the hinge Stainless steel |

(2)

|          |                               |
|----------|-------------------------------|
| <b>R</b> | mechanische Wiederanlaufsperr |
|----------|-------------------------------|

(3)

|             |                               |
|-------------|-------------------------------|
| <b>10</b>   | 1 NC contact                  |
| <b>102</b>  | 1 NC contacts / 1 NO contact  |
| <b>110</b>  | 2 NC contact                  |
| <b>1102</b> | 2 NC contacts / 1 NO contacts |
| <b>1110</b> | 3 NC contact                  |

(4)

|                |                                |
|----------------|--------------------------------|
| <b>without</b> | Screw connection               |
| <b>ST1</b>     | Connector bottom (M12, 8 pole) |

|                |  |
|----------------|--|
| <b>ST2</b>     | Connector top (M12, 8 pole)                    |
| (5)            |  |
| <b>without</b> | with additional hinge                          |
| <b>S</b>       | without additional hinge                       |
| (6)            |  |
| <b>30</b>      | Suitable for mounting to profile systems 30 mm |
| <b>35</b>      | Suitable for mounting to profile systems 35 mm |
| <b>without</b> | Suitable for mounting to profile systems 40 mm |
| <b>45</b>      | Suitable for mounting to profile systems 45 mm |
| (7)            |  |
| <b>without</b> | Switching angle NC contact at 4 degrees        |
| <b>5°</b>      | Switching angle NC contact at 5 degrees        |
| <b>8°</b>      | Switching angle NC contact at 8 degrees        |

## Pictures

### Product picture (catalogue individual photo)

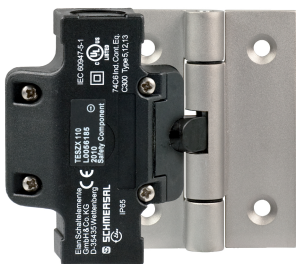

ID: ktez-f10  
 | 671.0 kB | .jpg | 352.778 x 314.678 mm - 1000 x 892 px - 72 dpi  
 | 50.5 kB | .png | 74.083 x 65.969 mm - 210 x 187 px - 72 dpi  
 | 76.3 kB | .jpg | 123.472 x 110.067 mm - 350 x 312 px - 72 dpi

### Dimensional drawing basic component

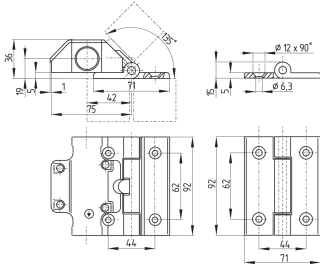

ID: ktes-g05

| 20.2 kB | .swf |

| 6.0 kB | .png | 74.083 x 60.325 mm - 210 x 171 px - 72 dpi

| 182.7 kB | .jpg | 352.778 x 287.867 mm - 1000 x 816 px - 72 dpi

## Switch travel diagram

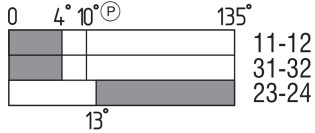

ID: ktes-s04

| 19.7 kB | .cdr |

| 1.9 kB | .png | 74.083 x 29.633 mm - 210 x 84 px - 72 dpi

| 53.7 kB | .jpg | 352.778 x 141.464 mm - 1000 x 401 px - 72 dpi

## Diagram

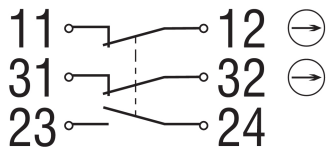

ID: ktes-k04

| 18.2 kB | .cdr |

| 78.5 kB | .jpg | 352.778 x 154.869 mm - 1000 x 439 px - 72 dpi

| 3.4 kB | .png | 74.083 x 32.456 mm - 210 x 92 px - 72 dpi

Schmersal, Inc., 15 Skyline Drive, Hawthorne, NY 10532

The details and data referred to have been carefully checked. Images may diverge from original. Further technical data can be found in the manual. Technical amendments and errors possible.

Generated on: 11/29/2023, 11:24 AM