



## TESZ1102/S

- 2 cable entries M 20 x 1.5
- Simple fitting, especially on 40 mm profiles
- Thermoplastic enclosure
- Double-insulated
- Good resistance to oil and petroleum spirit
- 111,5 mm x 92 mm x 36 mm

## Data

### Ordering data

Product type description	TESZ1102/S
Article number (order number)	101029153
EAN (European Article Number)	4030661448954
eCl@ss number, version 12.0	27-27-06-09
eCl@ss number, version 11.0	27-27-06-09
eCl@ss number, version 9.0	27-27-06-09
ETIM number, version 7.0	EC002591
ETIM number, version 6.0	EC002591

### Approvals - Standards

Certificates	BG IFA cULus CCC
--------------	---------------------------

## General data

Standards	BG-GS-ET-15 EN IEC 60947-5-1
Enclosure material	Plastic, glass-fibre reinforced thermoplastic, self-extinguishing
Material of the hinge	Aluminium
Gross weight	280 g

## General data - Features

mounting hinge	Yes
Number of auxiliary contacts	1
Number of safety contacts	2

## Safety classification

Standards	EN ISO 13849-1
Mission time	20 Year(s)

## Safety classification - Safety outputs

B <sub>10D</sub> Normally-closed contact (NC)	2,000,000 Operations
B <sub>10D</sub> Normally open contact (NO)	1,000,000 Operations

## Mechanical data

Mechanical life, minimum	1,000,000 Operations
Positive break angle	14 °
Positive break force, minimum	1 N

## Mechanical data - Connection technique

Termination	Screw terminals M20 x 1.5
Cable section, minimum	0.5 mm <sup>2</sup>
Cable section, maximum	1 mm <sup>2</sup>
Note (Cable section)	All indications including the conductor ferrules.

## Mechanical data - Dimensions

Length x Width x Height	Suitable for mounting to profile systems: 40 mm
Length of sensor	36 mm
Width of sensor	111.5 mm
Height of sensor	92 mm

## Ambient conditions

Degree of protection	IP65
Ambient temperature	-25 ... +65 °C

## Ambient conditions - Insulation values

Rated insulation voltage $U_i$	250 VAC
Rated impulse withstand voltage $U_{imp}$	2.5 kV

## Electrical data

Thermal test current	2.5 A
Utilisation category AC-15	230 VAC
Utilisation category AC-15	2 A
Utilisation category DC-13	24 VDC
Utilisation category DC-13	1 A

Switching element	NO contact, NC contact
Switching principle	Slow action
Switching frequency	120 /h
Material of the contacts, electrical	Silver

## Note

Note (General)	The opening angle has been set to 4° in factory. The additional hinge including mounting accessories is also available separately, part number TES/S
----------------	---

## Ordering code

Product type description:  
TESZ(1)(2)(3)(4)/(5)(6)/(7)

(1)

<b>without</b>	Material of the hinge Aluminium
<b>X</b>	Material of the hinge Stainless steel

(2)

<b>R</b>	mechanische Wiederanlaufsperr
----------	-------------------------------

(3)

<b>10</b>	1 NC contact
<b>102</b>	1 NC contacts / 1 NO contact
<b>110</b>	2 NC contact
<b>1102</b>	2 NC contacts / 1 NO contacts
<b>1110</b>	3 NC contact

(4)

<b>without</b>	Screw connection
<b>ST1</b>	Connector bottom (M12, 8 pole)

<b>ST2</b>	Connector top (M12, 8 pole)
(5)	
<b>without</b>	with additional hinge
<b>S</b>	without additional hinge
(6)	
<b>30</b>	Suitable for mounting to profile systems 30 mm
<b>35</b>	Suitable for mounting to profile systems 35 mm
<b>without</b>	Suitable for mounting to profile systems 40 mm
<b>45</b>	Suitable for mounting to profile systems 45 mm
(7)	
<b>without</b>	Switching angle NC contact at 4 degrees
<b>5°</b>	Switching angle NC contact at 5 degrees
<b>8°</b>	Switching angle NC contact at 8 degrees

## Pictures

### Product picture (catalogue individual photo)



ID: ktez-f06  
 | 598.2 kB | .jpg | 352.778 x 314.678 mm - 1000 x 892 px - 72 dpi  
 | 47.3 kB | .png | 74.083 x 65.969 mm - 210 x 187 px - 72 dpi

### Dimensional drawing basic component

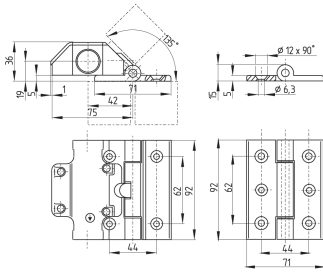

ID: 5tez-g03

| 43.9 kB | .cdr |

| 6.1 kB | .png | 74.083 x 61.031 mm - 210 x 173 px - 72 dpi

| 194.2 kB | .jpg | 352.778 x 291.042 mm - 1000 x 825 px - 72 dpi

## Switch travel diagram

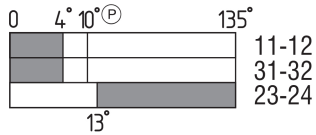

ID: ktes-s04

| 19.7 kB | .cdr |

| 1.9 kB | .png | 74.083 x 29.633 mm - 210 x 84 px - 72 dpi

| 53.7 kB | .jpg | 352.778 x 141.464 mm - 1000 x 401 px - 72 dpi

## Diagram

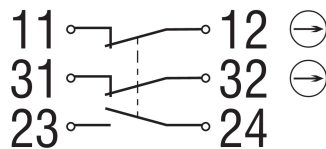

ID: ktes-k04

| 18.2 kB | .cdr |

| 78.5 kB | .jpg | 352.778 x 154.869 mm - 1000 x 439 px - 72 dpi

| 3.4 kB | .png | 74.083 x 32.456 mm - 210 x 92 px - 72 dpi

Schmersal, Inc., 15 Skyline Drive, Hawthorne, NY 10532

The details and data referred to have been carefully checked. Images may diverge from original. Further technical data can be found in the manual. Technical amendments and errors possible.

Generated on: 24/04/2023, 11:20