

ENVIRO-THERM THERMAL MANAGEMENT

HEAT EXCHANGER

Application
 Enviro-Therm® Heat Exchangers are designed for High-Efficiency and High-Performance Air-to-Air Heat Transfer. Designed with an internal closed loop system to provide protection from dust, oil and water. For indoor and outdoor application. Rugged, energy efficient, and reliable cooling system. For more details and Installation Information, consult our Installation Manual at www.saginawcontrol.com.

- Construction**
- Powder coated steel Cover RAL 7035 River Texture over Aluzinc coated steel.
 - Aluzinc coated steel internal parts.
 - Counter-flow core.
 - Filter-less design – low maintenance
 - Counterflow heat exchangers are finless, reducing the chances of clogging, and are easy to clean.
 - Threaded mounting studs provided for simple installation.
 - Digital Touchpad Programmable Controller.
 - Controller preset 95°F to cool – adjustable 68°F to 122°F.
 - Temperature differential hysteresis 5.4°F.
 - High temp alarm preset 131°F.
 - High performance ball bearing fans.
 - Door activated switch wiring provisions provided for easy installation.
 - Cage clamp terminal connector.

- Electrical**
- Frequency: 50/60 Hz
 - cULus Listed
 - CE
 - Surge protected and EMI compliant - IEC61000 and CE requirement

IS22 Industry Standards

UL Recognized Type 3R & 12
 IEC 60529 IP54



Catalog No.	Height (A)	Width (B)	Depth (C)	Cooling Capacity	Voltage	Line Amps	Startup Amps
SCE-HE04W120V	20.00	7.50	5.95	4 (W/F°)	115V	0.48	.70

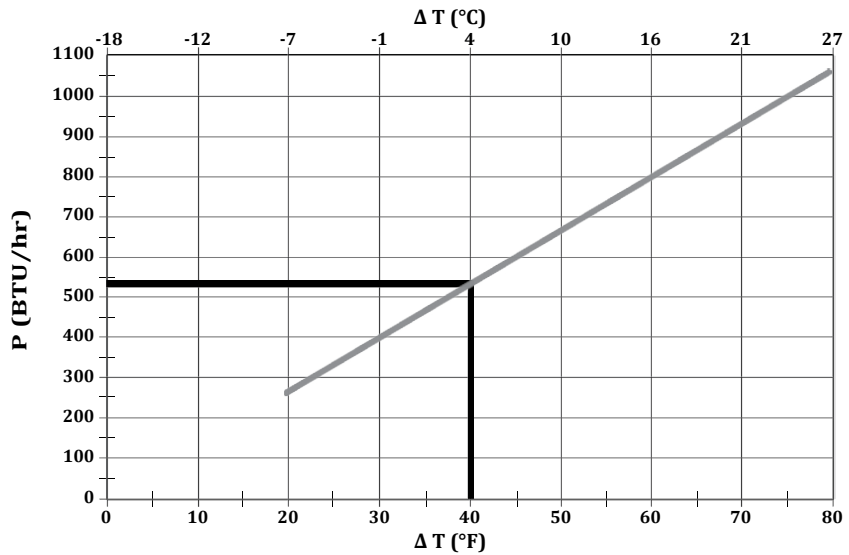

Catalog No.	Height (A)	Width (B)	Depth (C)	Cooling Capacity	Voltage	Line Amps	Startup Amps
SCE-HE08W120V	29.50	10.00	5.95	8 (W/F°)	115V	0.48	0.70

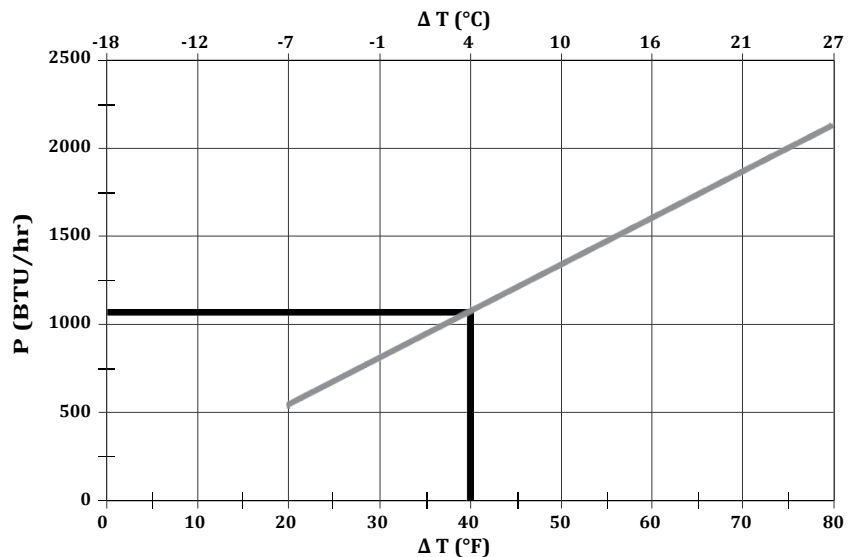

ENVIRO-THERM THERMAL MANAGEMENT HEAT EXCHANGER

Catalog No.	Height (A)	Width (B)	Depth (C)	Cooling Capacity	Voltage	Line Amps	Startup Amps
SCE-HE18W120V	29.66	10.24	5.95	18 (W/F°)	115V	1.40	1.60

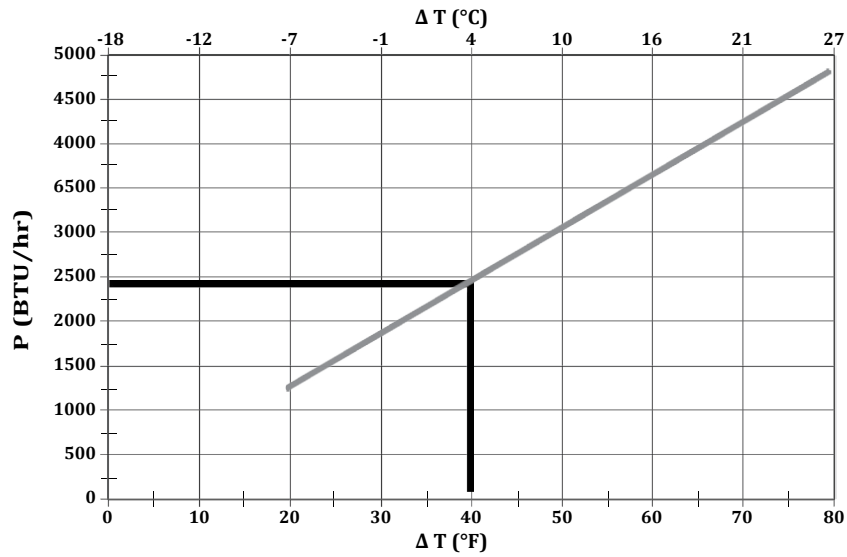

Catalog No.	Height (A)	Width (B)	Depth (C)	Cooling Capacity	Voltage	Line Amps	Startup Amps
SCE-HE24W120V	47.16	10.24	5.95	24 (W/F°)	115V	1.80	2.20

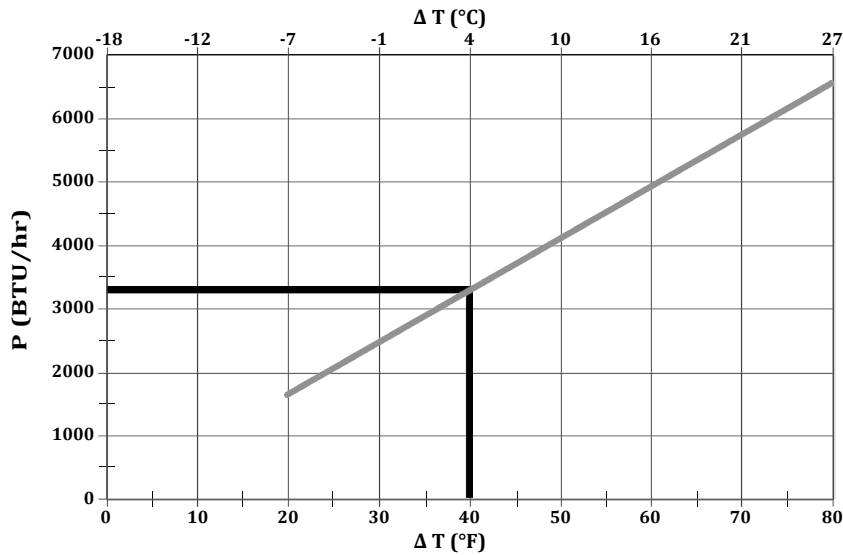

ENVIRO-THERM® HEAT EXCHANGERS

TECHNICAL DATA

SCE-HE18WI20V

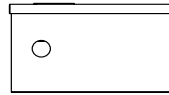
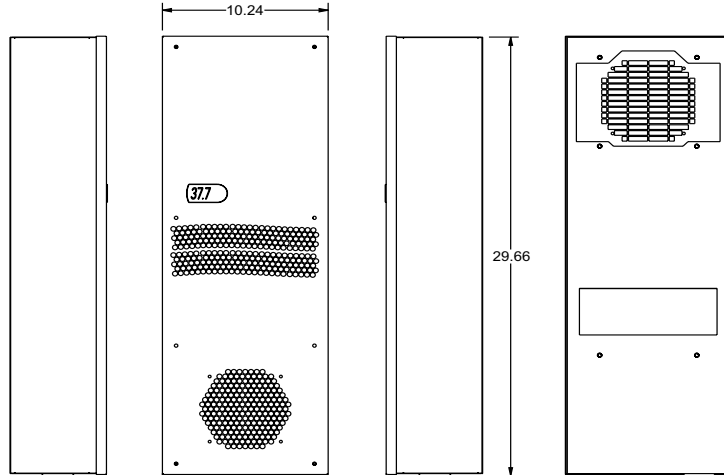
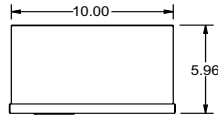
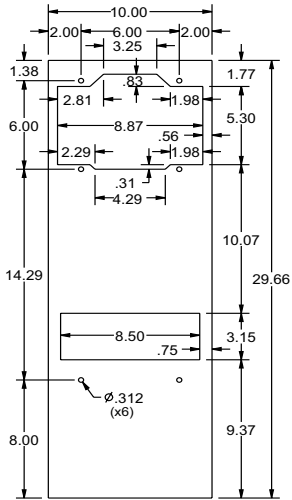

SCE-HE24WI20V

