

## Safety switch TX with guard locking and guard lock monitoring



- ▶ Auxiliary release on the front
- ▶ Escape release on the rear optional



### Approach direction



Horizontal  
Adjustable in 90° steps.

### Auxiliary release

Is used for releasing the guard locking with the aid of a tool. To protect against tampering, the auxiliary release is sealed with sealing lacquer.

### Escape release

This is used for manual release of guard locking from within the danger area without tools. With identification of On/Off position.

### Guard locking type

**TX1** Closed-circuit current principle, guard locking by spring force. Release by control of AS-i output 0.

### Control of the guard locking solenoid

The guard locking solenoid is controlled by the control system via AS-Interface bus bit D0. In addition the 24V connection can be switched safely.

### AS-Interface inputs

- ▶ **D0, D1** Positively driven contact 1 (safety door monitoring)
- ▶ **D2, D3** Positively driven contact 2 (guard lock monitoring)

Evaluation is performed via a safety monitor.

### AS-Interface outputs

- ▶ **D1** Red LED
- ▶ **D2** Green LED

### Internal LED function display

- ▶ The *Power* LED indicates the operating voltage on the bus.
- ▶ The *Fault* LED indicates if a fault has been detected on the AS-Interface bus.

### External LED function display

- ▶ The green and the red LEDs can be controlled as required by the control system via the bus using bits D1 and D2.

### Without escape release Plug connector M12, 4-pin

#### Dimension drawing

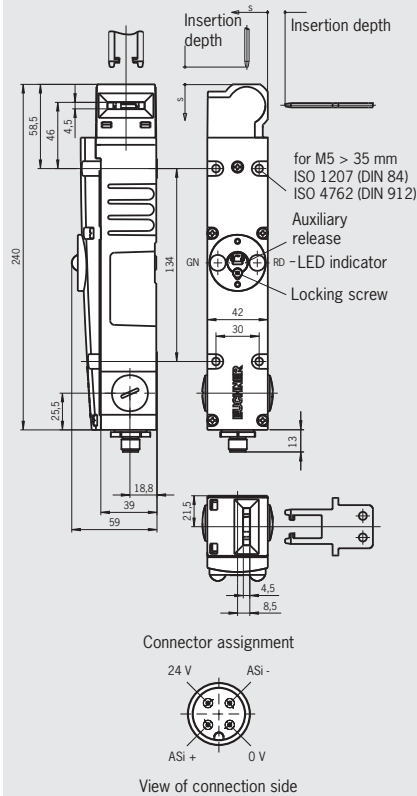

Please order actuator and connection material separately. For detailed information and suitable accessories, enter the order number for the product in the search box at [www.euchner.com](http://www.euchner.com).

### With escape release Plug connector M12, 4-pin

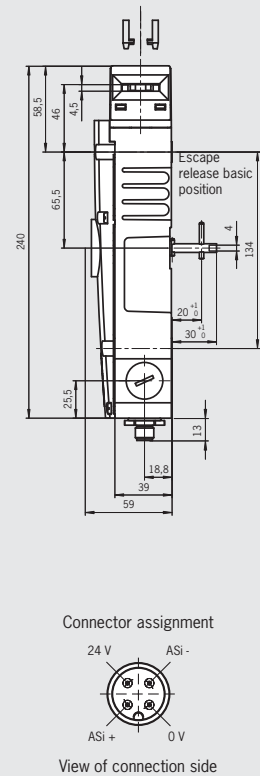

Please order actuator and connection material separately. For detailed information and suitable accessories, enter the order number for the product in the search box at [www.euchner.com](http://www.euchner.com).

### Ordering table

Series	Connection	Guard locking	Switching element	Version	Order no./ item
TX	SEM 4 Plug connector M12	1 Mechanical	SK: 1 NC ⊖ UK: 1 NC ⊖		<b>094403</b> TX1B-A024SEM4AS1
				<b>C1991</b> with escape release	<b>095914</b> TX1B-A024SEM4AS1C1991