

**Inductive sensors special versions**

**ILFK**

**sample drawing**

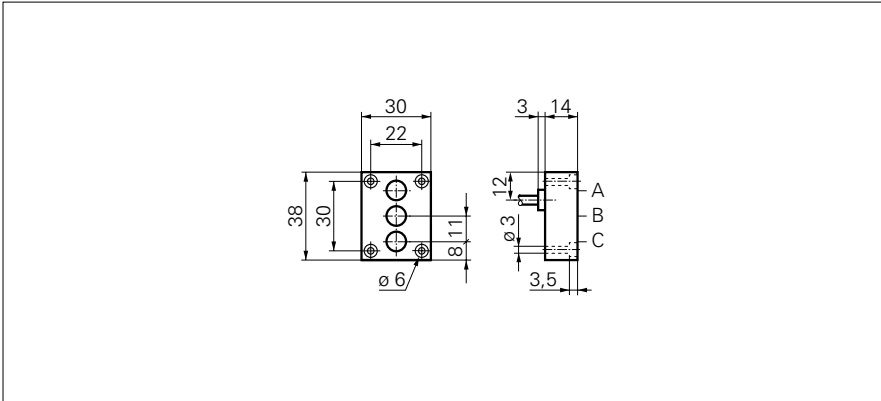

**general data**

special type	inductive code reader
hysteresis	1 ... 20 % of Sr

**electrical data**

switching frequency	< 2 kHz
voltage supply range +Vs	10 ... 30 VDC
output circuit	PNP make function (NO)
voltage drop Vd	< 2 VDC
output current	< 200 mA
short circuit protection	yes
reverse polarity protection	yes

**mechanical data**

type	rectangular
material (sensing face)	PA 6
housing material	PA 6
dimension	30 mm
connection types	cable, 2 m

**ambient conditions**

operating temperature	0 ... +60 °C
protection class	IP 67

**sample picture**



order reference	nominal sensing distance Sn	mounting type	housing length	current consumption max. (no load)
<b>ILFK 12P1101/I03</b>	4 mm	non-flush	38 mm	10 mA
<b>ILFK 12P1101/I06</b>	4 mm	non-flush	79 mm	20 mA
<b>ILFK 12P1501/I03</b>	2 mm	flush	38 mm	10 mA
<b>ILFK 12P1501/I06</b>	2 mm	flush	79 mm	20 mA